

BLUETONE 100

BLUETOOTH SPEAKER

GREAT BRITISH SOUND  SINCE 1968

Quick Start Guide

Important!



To enjoy Music from Bluetooth, you must first ensure that the Bluetone 100 is connected to mains power. Then pair the Bluetone 100 with your Bluetooth enabled device.

Plug in the Bluetone 100 to the mains power and the LED on the front will indicate solid red. ●
Press the power button  on top of the unit to turn it on.

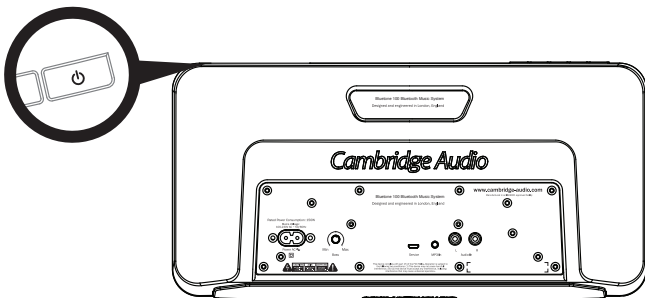
wvt



Bluetooth

Press the  button on the Bluetone 100 to enable pairing mode and the LED on the front will flash blue. 

Enable Bluetooth connectivity on your Bluetooth device (eg. phone, tablet, etc) and pair with the Bluetone 100 (you may need to consult your phone or tablet operating instructions).

Once paired, music from your device will play through the Bluetone 100.

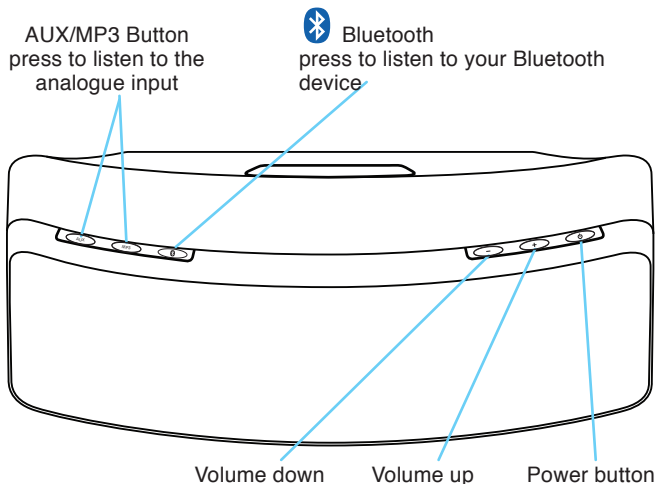

AUX/MP3 input

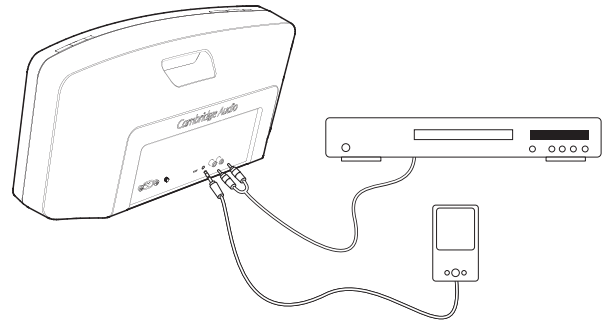

Press the MP3 or AUX button to select the analogue input and stop the playback of Bluetooth - the LED will turn to solid cyan ● (MP3) or solid orange ● (AUX).

Top tips

LED Indication

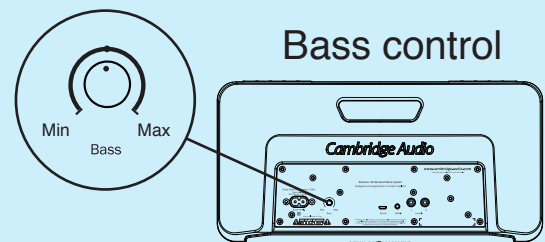
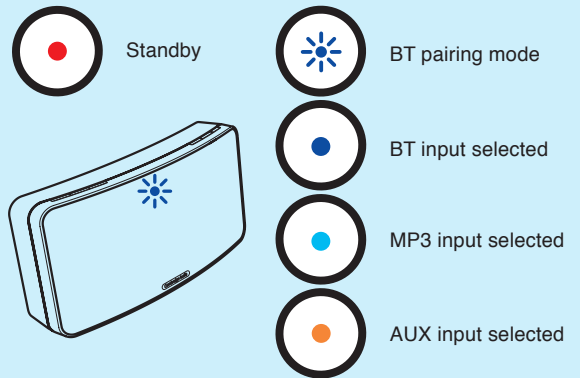

Adjust the bass of your Bluetone 100 to your listening environment.

Auto power down

To save power, if no buttons on the unit have been pressed for a period of time, it will automatically turn itself off.

To talk to us, call +44 (0)203 514 1521 (UK Local) or 1-877-357-8204 (USA)

Cambridge Audio