

Made for



iPod



iPhone



iPad

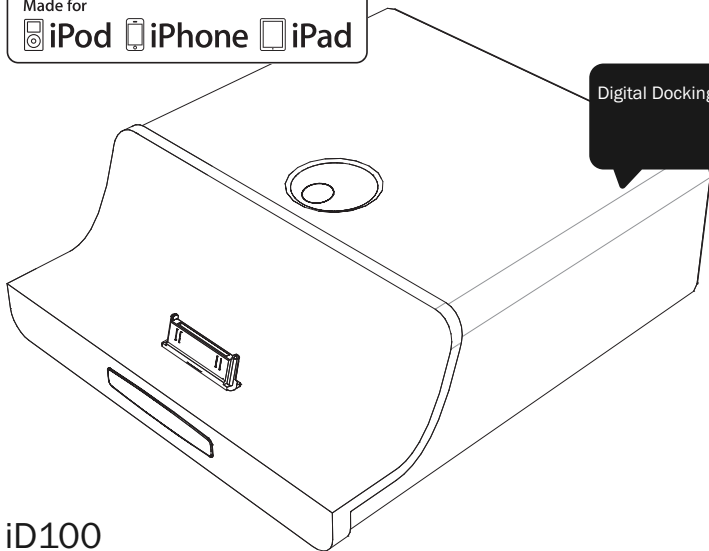

Digital Docking Station for iPod®
User's manual

2

ENGLISH

iD100

 **Cambridge Audio**

Your music + our passion



Contents

Introduction	3
Important safety instructions	4
Limited warranty	7
Rear panel connections.....	8
Front panel	10
Connections	12
Remote control.....	14
Operating instructions	17
Technical specifications	18
Troubleshooting	19

Make sure you register your purchase!
Visit: www.cambridgeaudio.com/sts

By registering, you'll be the first to know about:

- **Future product releases**
- **Software upgrades**
- **News, events and exclusive offers plus competitions!**

This guide is designed to make installing and using this product as easy as possible. Information in this document has been carefully checked for accuracy at the time of printing; however, Cambridge Audio's policy is one of continuous improvement, therefore design and specifications are subject to change without prior notice.

This document contains proprietary information protected by copyright. All rights are reserved. No part of this manual may be reproduced by any mechanical, electronic or other means, in any form, without prior written permission of the manufacturer. All trademarks and registered trademarks are the property of their respective owners.

© Copyright Cambridge Audio Ltd 2011

iPhone, iPod, iPod classic, iPod nano, and iPod touch are trademarks of Apple Inc., registered in the U.S. and other countries. iPad is a trademark of Apple Inc.

"Made for iPod," "Made for iPhone," and "Made for iPad" mean that an electronic accessory has been designed to connect specifically to iPod, iPhone, or iPad, respectively, and has been certified by the developer to meet Apple performance standards. Apple is not responsible for the operation of this device or its compliance with safety and regulatory standards. Please note that the use of this accessory with iPod, iPhone, or iPad may affect wireless performance.

iD100

Introduction

Thank you for purchasing this Cambridge Audio iD100 digital iPod® dock. We are confident that you will enjoy many years of listening pleasure from it. Like all Cambridge Audio products the iD100 adheres to three core principles – stunning performance, ease of use and incredible value.

The iD100 enables you to get the very best audio and video quality from most variants of the iPod. The iD100 also works with the iPod feature of the iPhone® and iPad™.

The iD100 accesses the audio on the docked Apple product digitally providing a bit-perfect low jitter digital output via S/P DIF, Toslink or AES/EBU connections. These can be connected to the digital inputs of a suitable DAC, Digital Amplifier or the digital inputs on many A/V Receivers etc.

The iD100 allows the digital output of any audio file your Apple product itself supports including lossless files for unprecedented sound quality.

In addition, video outputs via Composite Video, S-Video or Component Video* allow the viewing of video content.

The supplied remote allows browsing of the iPod / iPad / iPhone via its own display.

Charging and Syncing of the iPod can both be turned On or Off via the remote which can also control basic features of Cambridge Audio Amplifiers and Receivers. The iD100 also features an environmentally friendly low power (<1w) standby circuit.

* Composite / Component lead supplied

Ultimate sound quality depends on the whole of your system your dealer can also supply excellent quality Cambridge Audio interconnects to ensure your system realises its full potential.

Thank you for taking the time to read this manual; we do recommend you keep it for future reference.



Matthew Bramble
Cambridge Audio Technical Director
and the iD100 development team.



Important safety instructions

For your own safety please read the following important safety instructions carefully before attempting to connect this unit to the mains power supply. They will also enable you to get the best performance from and prolong the life of the unit:

1. Read these instructions.
2. Keep these instructions.
3. Heed all warnings.
4. Follow all instructions.
5. Do not use this apparatus near water.
6. Clean only with a dry cloth.
7. Do not block any ventilation openings. Install in accordance with the manufacturer's instructions.
8. Do not install near any heat sources such as radiators, heat registers, stoves, or other apparatus (including amplifiers) that produce heat.
9. Do not defeat the safety purpose of the polarized or grounding type plug. A polarized plug has two blades with one wider than the other. A grounding-type plug has two blades and a third grounding prong. The wide blade or the third prong are provided for your safety. If the provided plug does not fit into your outlet, consult an electrician for replacement of the obsolete outlet.
10. Protect the power cord from being walked on or pinched, particularly at plugs, convenience receptacles and the point where they exit from the apparatus.
11. Only use attachments/accessories specified by the manufacturer.
12. Use with only the cart, stand, tripod, bracket, or table specified by the manufacturer, or sold with the apparatus. When a cart is used, use caution when moving the cart/ apparatus combination to avoid injury from tip-over.
13. Unplug this apparatus during lightning storms or when unused for long periods of time.



14. Refer all servicing to qualified service personnel. Servicing is required when the apparatus has been damaged in any way, such as the power-supply cord or plug having been damaged, liquid has been spilled or objects have fallen into the apparatus, the apparatus has been exposed to rain or moisture, does not operate normally, or has been dropped.

WARNING

- To reduce the risk of fire or electric shock, do not expose this unit to rain or moisture.
- Batteries (battery pack or batteries installed) shall not be exposed to excessive heat such as sunshine, fire or the like.

The unit must be installed in a manner that makes disconnection of the mains plug from the mains socket outlet (or appliance connector from the rear of the unit) possible. Where the mains plug is used as the disconnect device, the disconnect device shall remain readily operable. Only use the mains cord supplied with this unit.

Please ensure there is ample ventilation (at least 10cm clearance all round). Do not put any objects on top of this unit. Do not situate it on a rug or other soft surface and do not obstruct any air inlets or outlet grilles. Do not cover the ventilation grilles with items such as newspapers, tablecloths, curtains, etc.

This unit must not be used near water or exposed to dripping or splashing water or other liquids. No objects filled with liquid, such as vases, shall be placed on the unit.

iD100



The lightning flash with the arrowhead symbol within an equilateral triangle is intended to alert the user to the presence of un-insulated 'dangerous voltage' within the product's enclosure that may be of sufficient magnitude to constitute a risk of electric shock to persons.

The exclamation point within an equilateral triangle is intended to alert the user to the presence of important operating and maintenance instructions in the service literature relevant to this appliance.



The symbol on this product indicates that it is of CLASS II (double insulated) construction.

**WEEE symbol**

The crossed-out wheeled bin is the European Union symbol for indicating separate collection for electrical and electronic equipment. This product contains electrical and electronic equipment which should be reused, recycled or recovered and should not be disposed of with unsorted regular waste. Please

return the unit or contact the authorised dealer from whom you purchased this product for more information.

**CE mark**

This product complies with European Low Voltage (2006/95/EC), Electromagnetic Compatibility (2004/108/EC) and Environmentally-friendly design of Energy-related Products (2009/125/EC) Directives when used and installed according to this instruction manual. For continued compliance only Cambridge Audio accessories should be used with this product and servicing must be referred to qualified service personnel.

**C-Tick mark**

This product meets the Australian Communications Authority's Radio communications and EMC requirements.

**Gost-R Mark**

This product meets Russian electronic safety approvals.

FCC regulations

NOTE: THE MANUFACTURER IS NOT RESPONSIBLE FOR ANY RADIO OR TV INTERFERENCE CAUSED BY UNAUTHORIZED MODIFICATIONS TO THIS EQUIPMENT. SUCH MODIFICATIONS COULD VOID THE USER AUTHORITY TO OPERATE THE EQUIPMENT.

This device complies with part 15 of the FCC Rules. Operation is subject to the following two conditions:

- 1) This device may not cause harmful interference;
- 2) This device must accept any interference, including interference that may cause undesired operation.



These limits are designed to provide reasonable protection against harmful interference in a residential installation. This equipment generates, uses and can radiate radio frequency energy and, if not installed and used in accordance with the instructions, may cause harmful interference to radio communications. However, there is no guarantee that interference will not occur in a particular installation.

If this equipment does cause harmful interference to radio or television reception, which can be determined by turning the equipment off and on, the user is encouraged to try to correct the interference by one or more of the following measures:

- Re-orient or relocate the receiving antenna.
- Increase the separation between the equipment and receiver.
- Connect the equipment into an outlet on a circuit different from that to which the receiver is connected.
- Consult the dealer or an experienced radio/TV technician for help.



Important safety instructions cont.

Ventilation

IMPORTANT – The unit will become hot when in use. Do not stack multiple units on top of each other. Do not place in an enclosed area such as a bookcase or in a cabinet without sufficient ventilation. Ensure that small objects do not fall through any ventilation grille. If this happens, switch off immediately, disconnect from the mains supply and contact your dealer for advice.

Positioning

Choose the installation location carefully. Avoid placing it in direct sunlight or close to a source of heat. No naked flame sources, such as lighted candles, should be placed on the unit. Also avoid locations subject to vibration and excessive dust, cold or moisture. The unit can be used in a moderate climate.

This unit must be installed on a sturdy, level surface. Do not place in a sealed area such as a bookcase or in a cabinet. Do not place the unit on an unstable surface or shelf. The unit may fall, causing serious injury to a child or adult as well as serious damage to the product. Do not place other equipment on top of the unit.

Due to stray magnetic fields, turntables or CRT TVs should not be located nearby due to possible interference.

Electronic audio components have a running in period of around a week (if used several hours per day). This will allow the new components to settle down and the sonic properties will improve over this time.

Power sources

The unit should be operated only from the type of power source indicated on the marking label. If you are not sure of the type of power supply to your home, consult your product dealer or local power company.

To turn the unit off, unplug it from the mains socket.

WARNING: Do not continue using the external power supply if it is broken.

Overloading

Do not overload wall outlets or extension cords as this can result in a risk of fire or electric shock. Overloaded AC outlets, extension cords, frayed power cords, damaged or cracked wire insulation and broken plugs are dangerous. They may result in a shock or fire hazard. Be sure to insert each power cord securely. To prevent hum and noise, do not bundle the interconnect leads with the power cord or speaker leads.

Cleaning

To clean the unit, wipe its case with a dry, lint-free cloth. Do not use any cleaning fluids containing alcohol, ammonia or abrasives. Do not spray an aerosol at or near the unit.

Battery disposal

Please dispose of any discharged batteries according to local environmental/electronic waste disposal guidelines.

Servicing

These units are not user serviceable. Never attempt to repair, disassemble or reconstruct the unit if there seems to be a problem. A serious electric shock could result if this precautionary measure is ignored. In the event of a problem or failure, please contact your dealer.

Limited warranty

Cambridge Audio warrants this product to be free from defects in materials and workmanship (subject to the terms set forth below). Cambridge Audio will repair or replace (at Cambridge Audio's option) this product or any defective parts in this product. Warranty periods may vary from country to country. If in doubt consult your dealer and ensure that you retain proof of purchase.

To obtain warranty service, please contact the Cambridge Audio authorised dealer from which you purchased this product. If your dealer is not equipped to perform the repair of your Cambridge Audio product, it can be returned by your dealer to Cambridge Audio or an authorised Cambridge Audio service agent. You will need to ship this product in either its original packaging or packaging affording an equal degree of protection.

Proof of purchase in the form of a bill of sale or receipted invoice, which is evidence that this product is within the warranty period, must be presented to obtain warranty service.

This Warranty is invalid if (a) the factory-applied serial number has been altered or removed from this product or (b) this product was not purchased from a Cambridge Audio authorised dealer. You may call Cambridge Audio or your local country Cambridge Audio distributor to confirm that you have an unaltered serial number and/or you made a purchase from a Cambridge Audio authorised dealer.

This Warranty does not cover cosmetic damage or damage due to acts of God, accident, misuse, abuse, negligence, commercial use, or modification of, or to any part of, the product. This Warranty does not cover damage due to improper operation, maintenance or installation, or attempted repair by anyone other than Cambridge Audio or a Cambridge Audio dealer, or authorised service agent which is authorised to do Cambridge Audio warranty work. Any unauthorised repairs will void this Warranty. This Warranty does not cover products sold AS IS or WITH ALL FAULTS.

REPAIRS OR REPLACEMENTS AS PROVIDED UNDER THIS WARRANTY ARE THE EXCLUSIVE REMEDY OF THE CONSUMER. CAMBRIDGE AUDIO SHALL NOT BE LIABLE FOR ANY INCIDENTAL OR CONSEQUENTIAL DAMAGES FOR BREACH OF ANY EXPRESS OR IMPLIED WARRANTY IN THIS PRODUCT. EXCEPT TO THE EXTENT PROHIBITED BY LAW, THIS WARRANTY IS EXCLUSIVE AND IN LIEU OF ALL OTHER EXPRESS AND IMPLIED WARRANTIES WHATSOEVER INCLUDING, BUT NOT LIMITED TO, THE WARRANTY OF MERCHANTABILITY AND FITNESS FOR A PRACTICAL PURPOSE.

Some countries and US states do not allow the exclusion or limitation of incidental or consequential damages or implied warranties so the above exclusions may not apply to you. This Warranty gives you specific legal rights, and you may have other statutory rights, which vary from state to state or country to country.

For any service, in or out of warranty, please contact your dealer.

Rear panel connections

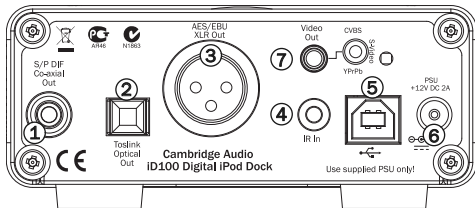

1. S/P-DIF Outputs (RCA/Phono & Optical)

For output to a separate DAC or the digital input on an amplifier or A/V receiver. To obtain best results, use a high quality 75ohm digital RCA interconnect cable (not one designed for normal audio use).

2. TOSLINK Optical digital output

Used to connect to the input of a separate DAC or the digital input on an amplifier or A/V receiver. Use a high quality TOSLINK fibre optic interconnect cable.

3. AES/EBU XLR output

Used to connect to a separate DAC or the digital input on an amplifier or A/V receiver that supports the AES/EBU balanced digital input standard.

- A 110 ohm balanced XLR cable designed for AES/EBU digital audio is required.

- To obtain the best results from your system we recommend using only high quality Cambridge Audio interconnects. This will ensure that you hear your system as we designed it. Please ask your dealer for details.

4. IR (Infrared) input

An IR input is also provided that allows modulated IR remote control commands to be received electrically by the unit. This is for connection to the IR Emitter Out for suitable repeaters or custom install systems.

iD100

5. USB connection

Used to sync your Apple device with iTunes™. Connect the USB port to your PC using a high quality USB cable (Type B to Type A).

6. +12V DC In terminal

Connect the iD100 to the supplied AC adaptor only.

7. Video output

To view video content connect the iD100 Video Out (Jack Socket, 4-Pole) to a TV/monitor using the supplied cable. See below for the right Video Format Selection switch setting.

Note: Also make sure the right source input is selected on the TV/Monitor.

Composite – Connect the iD100 to a TV/monitor with the supplied cable using the single Yellow/Blue RCA/PHONO connector.

Component – Component (Y, Pb, Pr) is a superior quality alternative. Connect the iD100 to a TV/monitor with the supplied component cable using all three RCA connectors. Make sure the colour coded RCA's are plugged into the matching connectors (RED/GREEN/BLUE) on the TV/Monitor.

S-Video – S-Video can also be used but you will need to obtain a suitable mini-jack to S-Video such as those used by camcorders. Contact your dealer for details.

Video select switch

Set the toggle switch to select the correct video format output.



Switch position	Label	Cable connection
Top	CVBS	Composite
Middle	S-Video	Own cable must be used
Bottom	YPbPr	Component

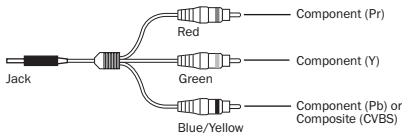

 *Cambridge Audio*

Front panel

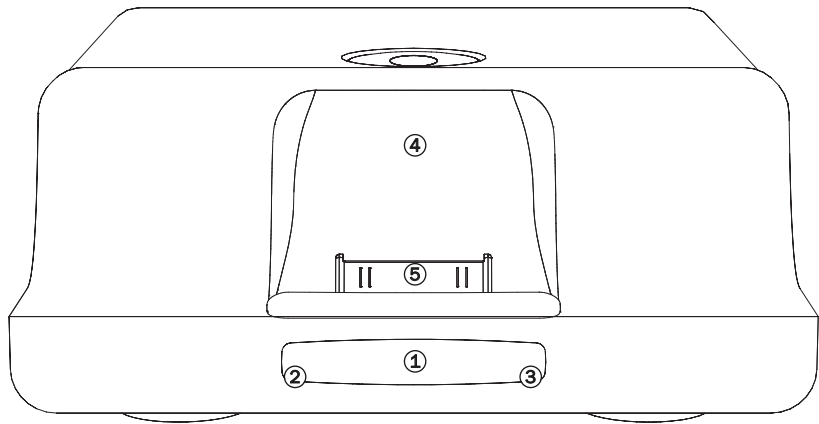

1. Remote control sensor

An IR sensor is situated behind the front window.

This receives IR commands from the supplied remote, Apple remotes or Cambridge Audio Azur Navigator 'iPod-compatible' remotes.

A clear and unobstructed line of sight between the remote control and the sensor is required.

2-3. Status LED's

Two status LED's are visible through the front IR window indicating the status as follows:

2 (Left blue LED)

Dim indicates Standby.
Bright Indicates Operation.

3 (Right blue LED)

Off indicates no iPod connected
Bright indicates iPod connected.
Slow flash indicates sync in progress
Flashing when remote control used indicates reception of IR codes.

4. Docking adaptors

Fit the required docking adaptor to support the model of your Apple device.

The supplied adaptors in the iD100 package suit multiple Apple products as below:

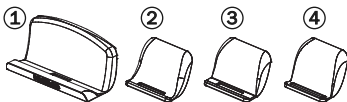

1. iPad
2. iPhone 3GS, and iPhone 3G
3. iPhone 4, iPod Touch (1st, 2nd, and 3rd generation), and iPod Classic
4. iPod Nano (3rd, 4th, and 5th generation)

Apple device compatibility

The iD100 is able to communicate with and control the following device models:

iPad
iPhone 4, iPhone 3GS, and iPhone 3G
iPod Touch (1st, 2nd, and 3rd generation)
iPod Classic
iPod Nano (3rd, 4th, and 5th generation)

Note: To prevent damaging the dock connector, do not twist the device when inserting it or removing it.

5. Dock connector

Gently insert the device into the dock. Excessive force may damage the connector.

Cambridge Audio

Connections

Note: Ensure all necessary connections from the iD100 are in place before connecting the power supply.

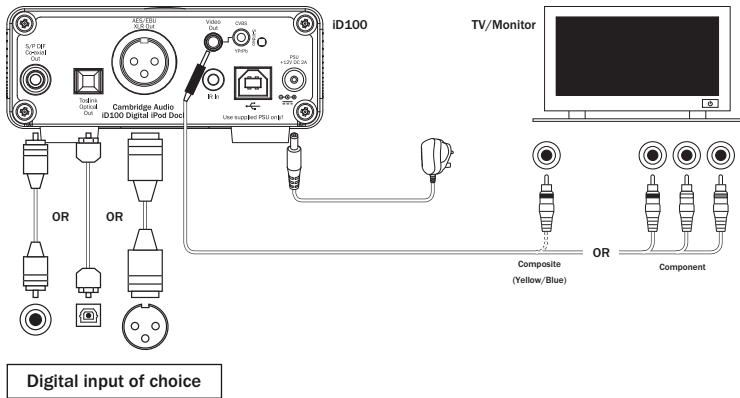

IMPORTANT! Before using the iD100 digital dock, we recommend updating your iPad/iPhone/iTouch to the latest firmware if using one of these devices.

Fit the required docking adaptor to support the model of your Apple device and carefully place the Apple device into the iD100 docking station.

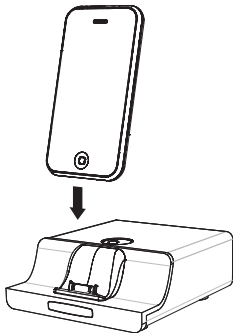

Note: To prevent damaging the dock connector, do not twist the Apple device when inserting or removing it.

Cambridge Audio

Remote control

When the battery is inserted, the remote will as default be set-up to control Cambridge Audio Amplifiers. To control Cambridge Audio A/V Receivers, press and hold the Standby button whilst inserting the battery.

Sync

Press to sync your apple device with your computer (via a suitable USB connection) using iTunes.

A "Connected" appears on the iPod's display. The right hand blue LED visible through the front IR window will flash On/OFF whilst sync is in progress.

Once the sync has started, do not press the Sync button again or remove the USB lead until it has finished.

For more syncing information, refer to your Apple device's manual.

Standby

Pressing this button brings the dock in and out of Standby.

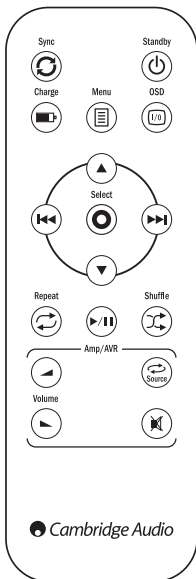

In Standby mode the left blue LED visible through the front IR window will be dim. Pressing the button when the dock is in Standby wakes up the iPod and dock (in the mode it was last in). The left blue LED visible through the front IR window turns on more brightly.

Note: The iD100 will take a few seconds to initialise the iPod when entering this mode.

Charge

Press to turn on charging for the Apple product and press again to turn off the charge function.

Menu

Press to go back to the previous menu. Hold down to return to the Home menu.

OSD

For future use, see Cambridge Audio website for details as they become available.

Navigation buttons

▲▼ Navigate up/down through the menus.

iD100

Skip

Press to select previous or next audio/video. Hold down to fast-forward or rewind audio/video.

Select

Use to select the current menu item.

Repeat

Press to cycle through the repeat modes.

Play/Pause

Press to play or pause audio/video playback.

Shuffle

Press to select audio/video shuffle.

The following buttons control the functions of a Cambridge Audio Amplifier/AV Receiver only

Volume

Press to adjust the volume on the Amplifier or A/V Receiver.

Source

Press to select the SOURCE input on the Amplifier or A/V Receiver.

Mute

Mutes the audio on the Amplifier or A/V Receiver. Press again to cancel mute.

Note: The iD100 is also compatible with Apple's own iPod remote and some Cambridge Audio Azur Navigator remote controls supplied with our products. Currently, almost all of the remotes in our Azur range are 'iPod-compatible'.

Please refer to the remote control section of the Azur product's manual for more information.



Remote control cont.

Pairing

By default as well as the supplied remote the iD100 will respond to any Apple remote.

The iD100 also supports the Apple pairing feature for people with several Apple products (see Apples own information on how this works).

You can pair the iD100 to a specific Apple remote by pointing it at the iD100 and holding down the RIGHT and MENU buttons for 6 seconds.

The iD100 will then respond to that Apple remote only (plus its own supplied handset).

You can un-pair the iD100 again (will respond to all Apple remotes) by pointing any Apple remote at the iD100 and holding down the LEFT and MENU buttons for 6 seconds.

The above operations do not affect the operation of the iD100s own supplied remote which always controls the iD100 and uses its own code set.

The remotes supplied with some Cambridge Audio Azur products also offer Apple codes and support the pairing function (see their manual for details).

iPad and iD100 Remote Limitations

Currently the iPod feature of the Apple iPad does not allow full browsing of content via accessories such as the iD100.

When in the iPod mode of the iPad the iD100 supports only PLAY/PAUSE, BACK, FORWARD, REPEAT & SHUFFLE (all basic transport commands).

This may change in future iPad software updates and is a function of the iPad software rather than the iD100.

Operating instructions

The iD100 allows direct digital audio output from compatible Apple products (see list in this manual).

Simply insert your Apple product and the dock will access and output digitally any audio played.

This includes Streaming Services Apps and any other Apps that generate audio.

Control of such Apps is done via the Apple products front panel user interface in the normal way.

For the iPod functionality of actual iPods or other devices that support the iPod function (iPhone, iPad etc.) control of what is playing is either achieved by their own front panel user interface or by the supplied remote handset.

The handset replicates Apples own functions which then operate in the manner that Apple decide (the functions are slightly different on each Apple device).

In addition there are a couple of extra features.

Sync On/Off

Sync On/Off allows you to make a permanent USB connection to a PC/Mac and choose when to turn on/off the actual appearance of the Apple device to the PC for syncing purposes.

Always wait for any Sync in progress to finish before turning Sync off this way.

Charge On/Off

This allows you to turn on and off the charging function to the docked apple product to either minimise constant charging of the battery or to minimise any charging noise when playing back high resolution audio.

Amp/AVR control

4 buttons are provided that allow Volume Up / Down, Source Selection and Mute on Cambridge Audio Amplifiers and A/V receivers.

See remote section for full details.



Technical specifications

Digital audio playback

AES/EBU

Signal type	Balanced
Signal level.....	2V
Output impedance.....	110 ohms
Connector.....	Pin 1 GND Pin 2 +VE Pin 3 -VE

S/PDIF

Signal type	Unbalanced
Signal level.....	500mV
Output impedance.....	75 ohm

Video format selection

Composite/S-Video/.....	3-position toggle switch
Component	

Connector

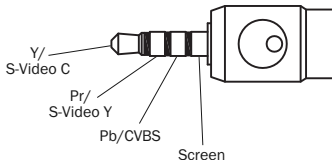

External IR

Input format.....	Modulated NEC
Connector.....	3.5mm jack socket

PC interface

Connector.....	USB Type-B USB 2.0 compatible
----------------	----------------------------------

Power input

Input voltage.....	+12V @ 2A
--------------------	-----------

Remote control

Battery.....	Cell type: V3, CR2032 or equivalent
--------------	-------------------------------------

Power consumption

Dependent on Apple product, up to 12W when full charging. <0.5W Standby.

Dimensions

105 x 45 x 121 mm

Weight

0.5kg/1.1lbs

Troubleshooting

There is no video on the TV

Check if your Apple device is correctly docked in the iD100.

Check if your Apple device is playing a video rather than an audio track.

Check the 3-position toggle switch is set to the correct video format.

Check you are using the right connections on the video cable and on the TV.

Check if your TV/receiver is turned on and that the right input source and type (composite or component) is selected.

Check if the video cable and DC adaptor are firmly and correctly connected.

Check you have your Apple device set correctly to PAL or NTSC.

There is no sound from my Stereo system

Check if your Apple device is correctly docked in the iD100.

Check if your Apple device is playing.

Check if your Amplifier/receiver is turned on, the right input/source is selected and the volume is turned up.

Check if the audio cables and DC adaptor are firmly and correctly connected.

The docking station does not charge the iPod's battery

Check if your Apple device is correctly docked in the iD100.

Check the AC/DC power adaptor is firmly plugged into the dock and the mains power socket outlet.

Check if you have turned charging Off (see remote section of the manual).

The remote control does not function

For the remote control to work as intended with your Apple device, the Apple device must be running the most updated Apple software. If you need to upgrade, simply visit the Apple device website and follow the instructions there for a free download. Go to: <http://www.apple.com>

If it still does not work, please unplug the power cable for one minute, then plug it back in (this resets the system).

Check if your Apple device is correctly docked in the iD100.

Try the remote from different locations and see if it works. Strong fluorescent lighting or other room conditions may cause the problem. Make sure nothing blocks the infra-red (IR) signal path between the remote and the iD100.

Check that the remote control's battery is correctly inserted and has not expired.

Cambridge Audio is a brand of Audio Partnership Plc
Registered Office: Gallery Court, Hankey Place,
London SE1 4BB, United Kingdom
Registered in England No. 2953313

www.cambridge-audio.com



© 2011 Cambridge Audio Ltd

AP27455/2